

# Introducing ZIP System® R-Sheathing Insulated Wall Panel

**ZIPsystem™**  
R-SHEATHING

**INSULATE  
AND PROTECT  
YOUR HOMES**



## 5-in-1 System with Layers of Innovation.

For installation convenience and exceptional, long-term performance, the all-in-one ZIP System® R-Sheathing panel provides a new approach to sealing and insulating the building envelope. One panel delivers thermal, air and moisture resistance, while providing excellent strength and durability.

- 1 Continuous Foam Insulation Provides Higher R-value**
  - Increases thermal performance while eliminating thermal bridging
  - Designed to meet new energy codes
- 2 Engineered Wood Provides Structure and Durability**
  - Nailable wood base for trim and accessories
  - Provides security against easy home intrusion
- 3 Built-In Water Resistant Barrier Eliminates Housewrap and Felt**
  - Eliminates costly rework
  - Instant rough dry-in with 180-day exposure guarantee
  - Superior drainage efficiency that channels moisture downward off the panel face
  - Permeable overlay promotes panel drying
- 4 Continuous Air Barrier Creates Greater Energy Efficiency**
  - Decreases unwanted air leakage into and out of a building
  - Helps protect the R-value of insulation, reducing heating and cooling costs
- 5 ZIP System™ Tape Permanently Seals All Panel Seams**
  - Acrylic formulation provides superior adhesion
  - Rigorously tested for long-lasting performance
  - Easily applied with tape gun and accessories



LIMITED WARRANTY  
**ZIP SYSTEM®**  
**30**  
YEAR  
SYSTEM

### Peace of Mind

ZIP System roof and wall sheathing panels are backed by a best-in-class 30-Year Limited Warranty

To locate a dealer or learn how to get  
**ZIPPED-in™** call 1.800.933.9220  
or visit [ZIPsystem.com](http://ZIPsystem.com)

## Insulation and durability in one installation. How's that for efficiency?

A single-piece design lets you avoid the hassles of multi-level systems. Just hang the panels and tape the seams for a wall system that provides structure, moisture protection and tight air seal, all in one.

### Physical Property Data Chart

ZIP System Properties	1"	1 1/2"
TECO Rated OSB	7/16"	7/16"
Foam	1/2"	1"
R-Value	3.6	6.6
Pieces Per Package	32 (4'x8' sheet)	31 (4'x8' sheet)
Square Feet Per Package	1024	992

Foam Performance		
Property	Test Method	Typical Results
Dimensional Stability	ASTM D 2126	< 2%
Compressive Strength	ASTM D 1621	20-25 psi
Water Absorption	ASTM C 209	< 1%
	ASTM D 2842	< 3.5%
Water Vapor Transmission	ASTM E96B	< 1.0 perm
Density	ASTM D 1622	Nominal 2.0 pcf
Flame Spread	ASTM E 84	40-60
Smoke Developed	ASTM E 84	50-170
Tensile Strength	ASTM D 1623	> 730 psf
Service Temperature		-40 to 200 F

ZIP System Performance		
Water Resistance of Coatings	ASTM D 2247-97	Passed 14-day exposure test
Drainage Efficiency	ASTM E 2273	> 90%
Water Vapor Transmission	ASTM E96B	12-16 perms (overlay)
Water Penetration	ASTM E 331-00	Passed
Air Barrier Assembly at 75Pa	ASTM E 2357-05	0.037 L/s·m <sup>2</sup>
Wind Driven Rain	TAS-100	Passed 100 mph
Accelerated Weathering	ASTM G 154	Passed

Long term thermal resistance values of the foam were determined in accordance with ASTM C 1289-02. The R-Value of 0.55 for 7/16" OSB was obtained from ASHRAE Handbook, Fundamentals.

**2009 IRC & IBC  
Code Recognized  
ESR-3373**

ZIP System™ R-Sheathing insulated wall panel



## GET REBATES

Visit [ZIPsystem.com](http://ZIPsystem.com) to learn more.

### ZIP System® R-Sheathing Installation Steps

#### Step 1 Fasten Panels

Use code-recognized fasteners and spacings

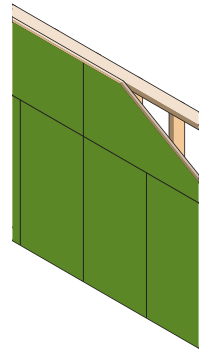

#### Step 2 Tape Seams

Tape horizontal and vertical seams

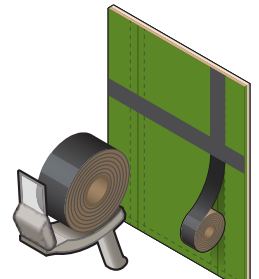

#### Step 3 Tape Corners

Tape inside and outside corners. Use the corner/valley tool to aid in corner tape installation

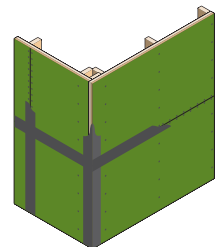

To locate a dealer or learn how to get ZIPPED-in™ call 1.800.933.9220 or visit [ZIPsystem.com](http://ZIPsystem.com)